



Pole mount adapter

NVB-SD6500PA



DIMENSIONS

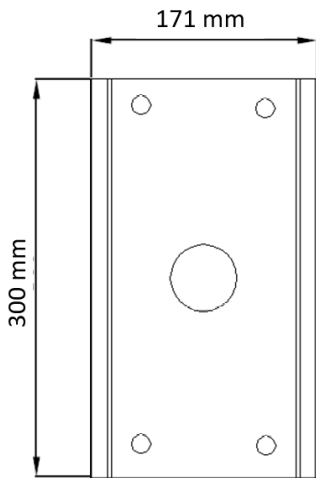

| | |
|-----------------|---|
| Type | pole mount adapter |
| Application | wall mount bracket, indoor/outdoor NVB-SD6500JB |
| Material | adapter: steel, fixing bands: stainless steel |
| Color | white |
| Load Capacity | 15 kg |
| Dimensions (mm) | 171 (W) x 300 (H) ϕ range = 140 ~ 300 |
| Weight | 2.8 kg |